

SUBMITTAL SHEET

JOB NAME	ITEM TAG
JOB LOCATION	PART NUMBER
CONTRACTOR	DATE
ENGINEER APPROVAL	DATE



SMARTCLICK™ CONNECTION SYSTEM FOR PE-RT AND PEX TUBING

Elbows, Tees, Couplings & Adapters

SmartClick™ fittings are designed for permanent installation onto ASTM F 876 and F 877 compliant PEX tubing and ASTM F2769 compliant PE-RT tubing. They are designed and approved for use in domestic and commercial applications for both potable water distribution and Hydronic heating systems. Copper, CPVC polybutylene (PB), composite PEX-A-PEX tubing and any type of iron pipe size (IPS) tubing or pipe must not be used!

Each transparent end connection can be rotated, to provide visual in addition to audible connection confirmation.

Approved to be utilized in underground applications and as manufactured joints without access panels for behind-the-wall installations. See Installation, Operation and Maintenance (IOM) instructions.

Available in nominal tubing sizes 1/2", 3/4" and 1".

Working Pressure, Non Shock (PSI)

Cold working pressure (CWP): 200 psi at 200° F, maximum temperature*

*May exceed the maximum service temperature or pressure of the PE-RT or PEX tubing.

Saturated Steam (WSP): Not suitable for steam service



Pictured:
Coupling



Pictured:
90° Elbow

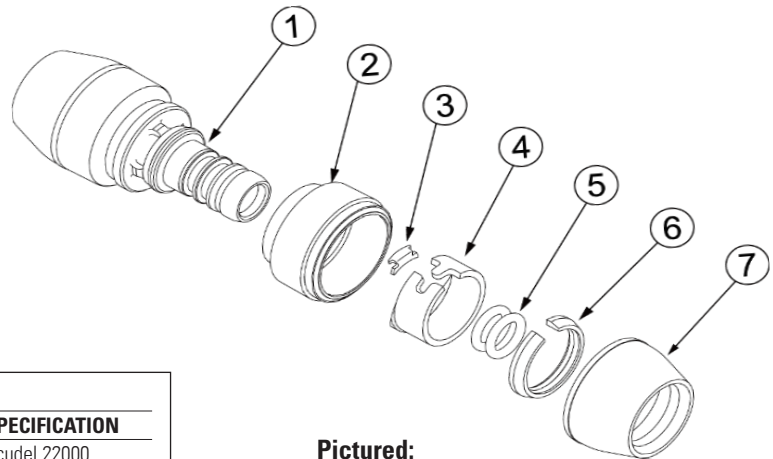

Pictured:
SmartClick Connection
Exploded View

MATERIAL SPECIFICATION		
PART	MATERIAL	SPECIFICATION
1 Insert	Modified Polyphenylsulfone (PPSU and PSU blend)	Acudel 22000
2 Sight glass	Polycarbonate (PC)	Commercial grade
3 Retention wedge	Spring steel	JIS S65C
4 Clamp	Spring steel	JIS S65C
5 O-rings (2)	EPDM	Commercial grade
6 Spacer	Polyphenylsulfone (PPSU)	ASTM D6394
7 End cap	Polycarbonate (PC)	Commercial grade

Certifications/Listings:

All SmartClick fittings are 3rd party certified (ICC-ES report PMG-1444) to the following standards and codes:

- ANSI/NSF 14: Plastic piping system components and related materials.
- ANSI/NSF 61: Drinking water system components health effects.
- ASSE 1061: Performance requirements for push-fit fittings.
- Uniform Plumbing Code (UPC) 2018, 2015, 2012, 2009
- International Plumbing Code (IPC) 2018, 2015, 2012, 2009
- International Residential Code (IRC) 2018, 2015, 2012, 2009
- National Plumbing Code of Canada (NPC) 2018, 2015, 2010, 2005
- California Plumbing Code (CPC) 2016, 2013, 2010
- City of Los Angles Plumbing Code 2017
- Code of Massachusetts Regulation 248 CMR 10.00 Uniform State Plumbing Code 2017, 2007

Standards:

ANSI/ASME B1.20.1 (pipe-threaded configurations only): Pipe Threads, General Purpose (Inch)