



K-160 6" EXTENDED SPLASH MOUNT FAUCET

Conforms To NSF 61/9 Lead Free Requirements



FAUCET AERATOR CONFORM TO
ASTM.A112.18.1M • 1.0 GPM/3.8 LP
THREAD: 55/64 - 27 FEMALE

Item #: _____ Qty #: _____
 Model #: _____
 Project #: _____

FEATURES:

- 6" swivel "D" style spout.
- 8" O.C. water supply.
- Quarter-turn wedge style handles.
- Colored hot & cold Indexes.
- 1.0 GPM/3.8 LPM Aerator. 60 PSI.

MATERIAL:

- Brass chrome plated body & spout.
- Chrome plated handles.



Click This Link To
View Assembly Sheet

Options & Accessories

Replacement "D" Spout
For K-160 Faucet
K-208SP



Faucet Repair Kit*
K-00B (Set of 2)

Includes 2 Cartridges and 2 Handles
With Red & Blue Indexes



Faucet Mounting Kit
K-06



Wrist Handles
K-316-LU (Set)



DIMENSIONS and SPECIFICATIONS

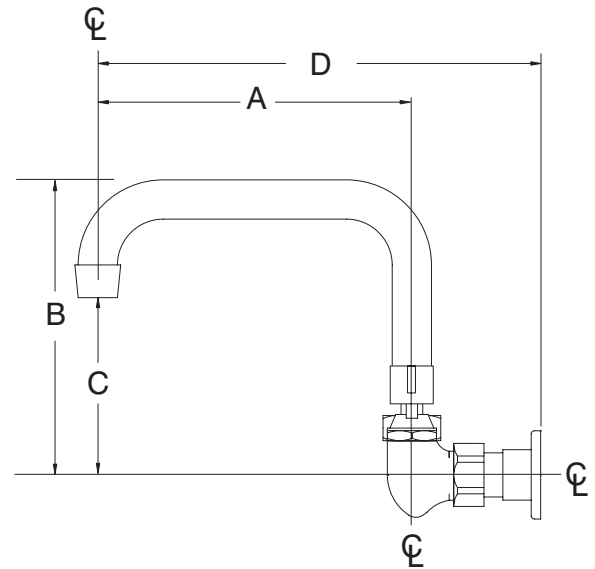

A Length	B Height	C	D	On Center Dimensions
6"	5"	4"	8"	8" O.C.

WARNING: Faucets on this page may expose you to chemicals, including lead, that are known to the State of California to cause cancer or birth defects or other reproductive harm. For more info, visit www.p65warnings.ca.gov.



Customer Service Available To Assist You **1-800-645-3166** 8:30 am - 7:00 pm E.S.T.

For Orders & Customer Service:
Email: customer@advancetabco.com or Fax: 631-242-6900

For Smart Fabrication™ Quotes:
Email: smartfab@advancetabco.com or Fax: 631-586-2933